

"I hope that this will prove a little lighthouse of knowledge. I hope it will lead you to a life more intellectual, more elevated and more spiritual..."

"I have built a lighthouse and furnished the lamp, but it is for you, inhabitants of Cape Elizabeth, to keep the lamp burning so that it shall shine over this town forever."

From the Thomas Memorial Library Dedication Address
William Widger Thomas Jr., April 22, 1919

Keeping the "lamp burning" by keeping true to the past, while moving forward towards a better future:

1. The design will be sensitive to the history of the town.
2. The project will preserve and enhance the character of the town center.
3. The building will be "green."
4. The new building will be able to accommodate future trends in technology and library programming.

New Library at a Glance:

- ✚ Increase space by ____ square feet
- ✚ New space for community functions
- ✚ Reconfigured young adult space
- ✚ Expanded children's area
- ✚ Improved quiet areas
- ✚ ADA upgrades for improved accessibility
- ✚ Estimated renovation costs: \$ _____
- ✚ Foundation goals of \$ _____

"THE PROBLEMS THAT EXIST IN THE WORLD TODAY CANNOT BE SOLVED BY THE LEVEL OF THINKING THAT CREATED THEM" - ALBERT EINSTEIN

For More Information:

Street Address, Suite 555
City, State 55555
P 555-555-5555
F 555-555-5555
E email@address.com
www.webaddress.com



Thomas Memorial Library and the 21st Century:

New Space to Grow

DISCOVERY

And

IMAGINATION

Future View: Thomas Memorial Library

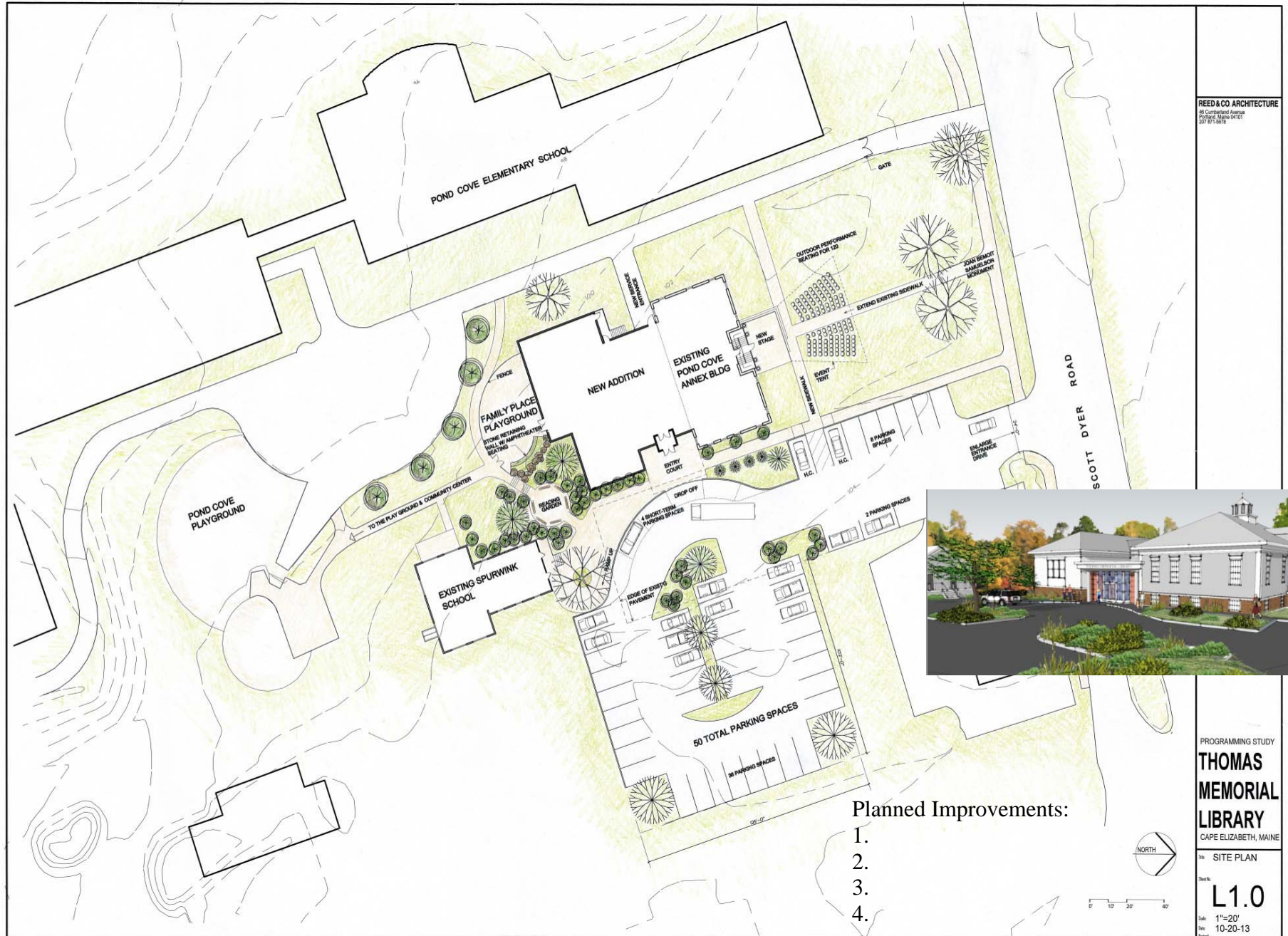

REED & CO ARCHITECTURE
 85 Cumberland Avenue
 Portland, Maine 04107
 207.871.5678



Planned Improvements:

- 1.
- 2.
- 3.
- 4.

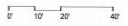

PROGRAMMING STUDY
**THOMAS
 MEMORIAL
 LIBRARY**
 CAPE ELIZABETH, MAINE
 1st SITE PLAN
 Sheet:
L1.0
 Date: 11-20-13
 Rev: 10-20-13